

Accessories for busbars



SI011980

Schrack-Info

Accessories adapted to the busbars of melting-fuse components.

DESCRIPTION	AVAILABLE	ORDER NO.
Busbar End Cap 2/3P		BS900186
Connection Terminal, Pin, Straight, 6-50mm², Long		BS900180
Connecting terminal 70/90mm², front connection for 1-pole comb-type busbar		SI011980
Connecting terminal for 1-pole comb type busbars		SI310280
Connecting terminal Al-Cu to 50mm²		BS900160



Connection-terminal



BS900176

Schrack-Info

Connection terminals for connection also together with busbars in a terminal of a device

6-25mm²



BS900172

Schrack-Info

Fork and pin-connection terminals for Cupper-conductors up to 25mm²

	BS900170	BS900171	BS900172	BS900173
Max.current:	63 A			
Max. voltage:	690 V			
Terminal-material:	brass			
Pin-material:	brass			
Cover:	PC / ABS - UL-V0			
Thermal properties:	EN ISO 306 = 138°C			
Screw:	St 5.8			
Stripped insulation:	12 mm			
Terminal cross section:	U - single wire: 6 - 25 mm ²			
	R - stranded wire: 6 - 25mm ²			
	K - flexible with sleeve: 4 - 16 mm ²			
	F - flexible with sleeve: 4 - 16 mm ²			
Torque of screw:	2 Nm			

BS900170 Dimensioned drawing

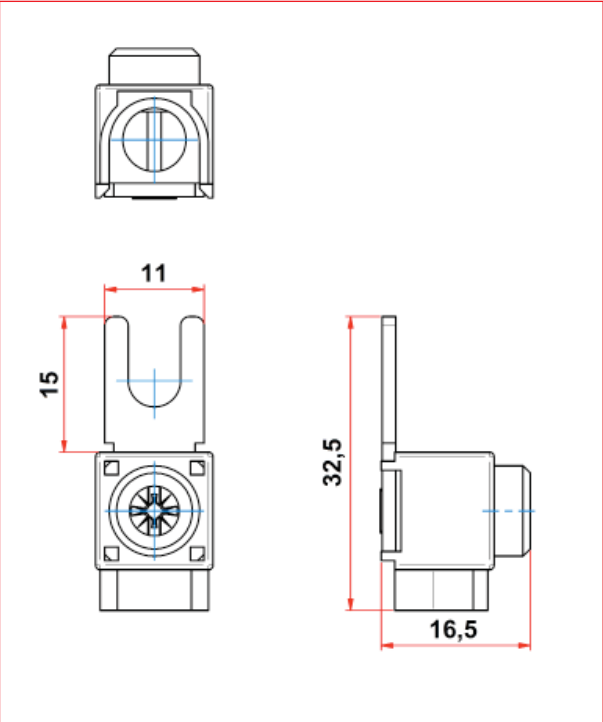

6-25mm²

BS900171 Dimensioned drawing

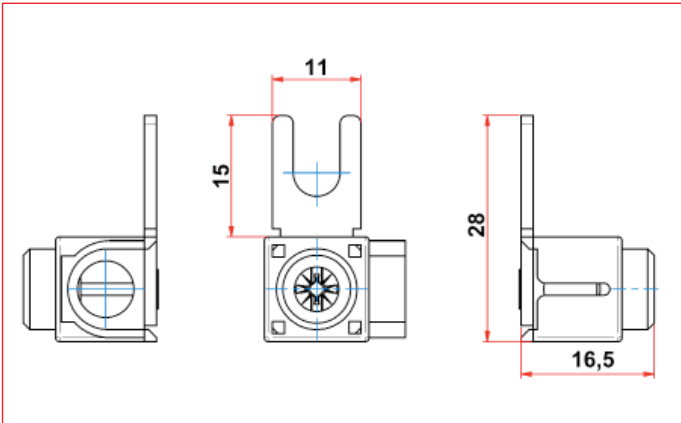



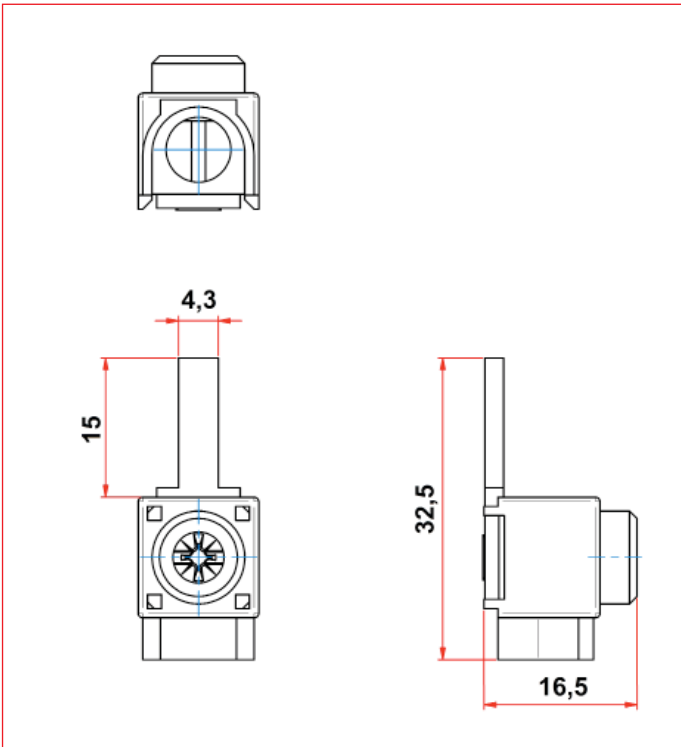

BS900172 Dimensioned drawing

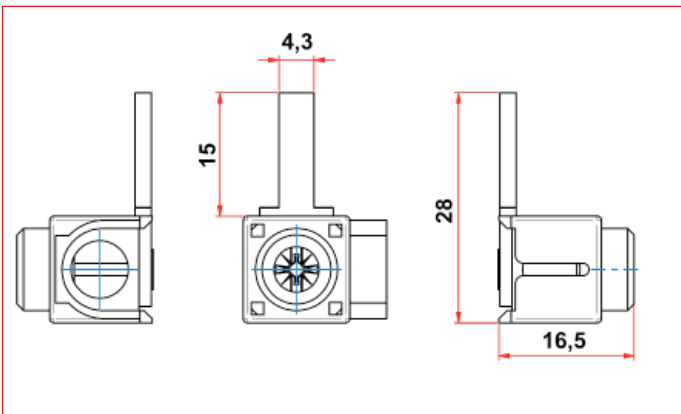

BS900173 Dimensioned drawing



DESCRIPTION	AVAILABLE	ORDER NO.
Connection Terminal, Fork, Straight, 6-25mm ² , Short		BS900170
Connection Terminal, Fork, cross-wise, 6-25mm ² , Short		BS900171
Connection Terminal, Pin, Straight, 6-25mm ² , Short		BS900172
Connection Terminal, Pin, cross-wise, 6-25mm ² , Short		BS900173
Conn. terminal, Pin. Straight 25mm ² , 2 screws w/o insulation		IK020019

50mm²



BS900176

Schrack-Info
Fork and Pin for Copper conductors up to 50mm²

	BS900174	BS900175	BS900176	BS900177	BS900178
Max. current:	100 A				
Max. voltage:	600 V				
Terminal-material:	brass				
Pin-material:	brass				
Cover:	PC / ABS - UL-V0				
Thermal properties:	EN ISO 306 = 138 °C				
Screw:	St 5.8				
Stripped insulation:	14 mm				
Terminal cross section:	U - single wire: 6 - 50 mm ²				
	R - stranded wire: 6 - 50 mm ²				
	K - flexible with sleeve: 4 - 35 mm ²				
	F - flexible with sleeve: 4 - 35 mm ²				
Torque of screw:	3-4 Nm				

BS900174 Dimensioned drawing

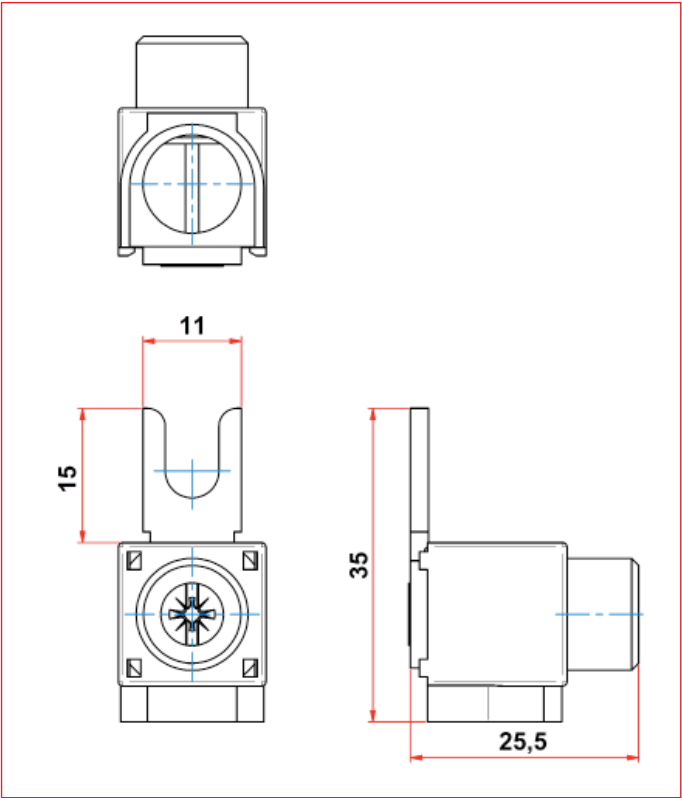

50mm²

BS900175 Dimensioned drawing

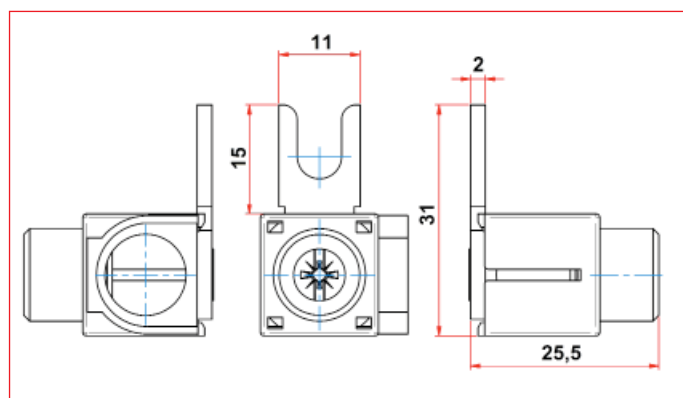

BS900176 Dimensioned drawing

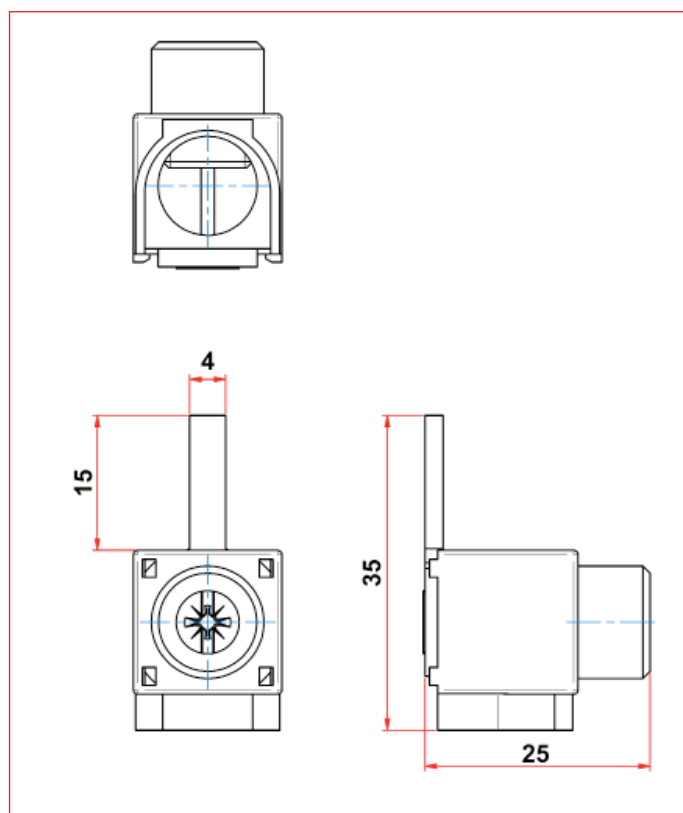

BS900177 Dimensioned drawing

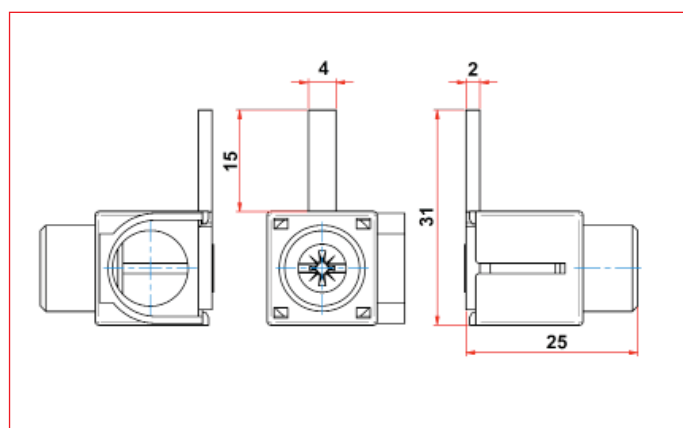





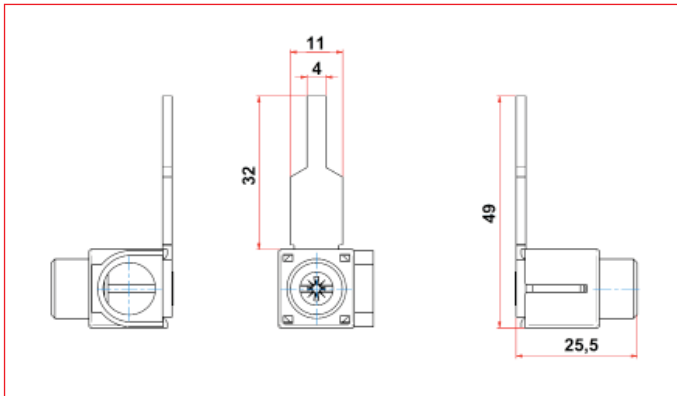

50mm²

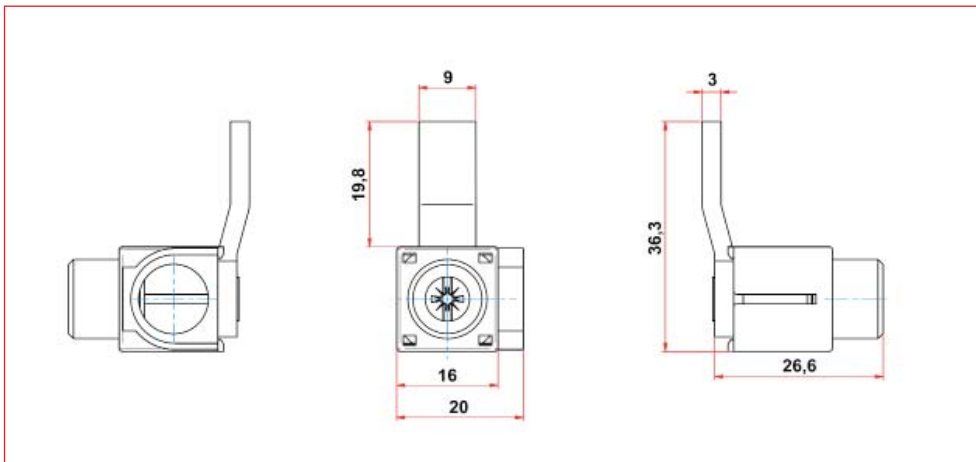
BS900178 Dimensioned drawing



BS900199 Dimensioned drawing



DESCRIPTION	AVAILABLE	ORDER NO.
Connection Terminal, Fork, Straight, 6-50mm ² , Short		BS900174
Connection Terminal, Fork, cross-wise, 6-50mm ² , Short		BS900175
Connection Terminal, Pin, Straight, 6-50mm ² , Short		BS900176
Connection Terminal, Pin, cross-wise, 6-50mm ² , Short		BS900177
Connection Terminal, Pin, cross-wise, 6-50mm ² , Long		BS900178
Connection Terminal 50mm ² , Pin 20x9mm cross-wise		BS900199



Order no. blue: on stock, usually ready for delivery on the day of order

Aluminium 50mm²



BS900160

Schrack-Info

- This terminal is suitable for ALU and CU conductors.
- Please pay attention to the common handling guidelines when connecting the Aluminum conductors. Clean and brush the contact surfaces and lubricate them with an appropriate grease.
- As precaution the connections should get retightened after 6-8 weeks.

	BS900160
Max.current:	80 A
Max. voltage:	690 V
Standards:	IEC 60998-1 / IES 60998-2-1 / IEC 60999-2
Terminal-material:	Aluminium
Pin-material:	tin plated
Cover:	PA - V0
Thermal properties:	EN ISO 306 = 138°C
Screw:	Steel
Stripped insulation:	14 mm
Protection class:	IP 00
Terminal cross section:	U - single wire: 16 - 50 mm² R - stranded wire: 16 - 50 mm² K - flexible with sleeve: 16 - 35 mm² F - flexible with sleeve: 16 - 35 mm²
Torque of screw:	7,5 Nm

BS900160 Dimensioned drawing

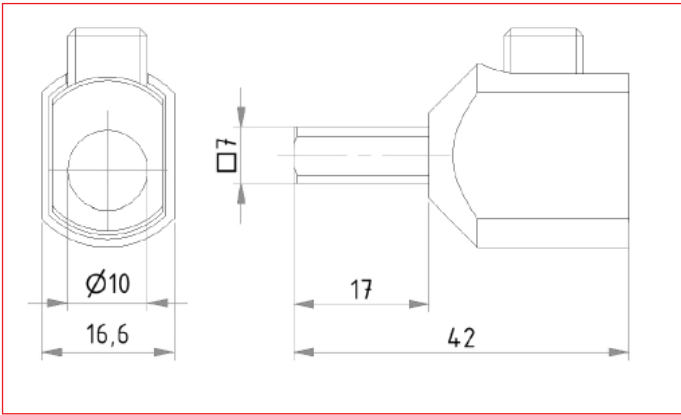

DESCRIPTION	AVAILABLE	ORDER NO.
Connecting terminal Al-Cu to 50mm²		BS900160

