

Modul-Connect



ISS90003



ISS90004

Schrack-Info

The first busbar with which RCCB switches, RCBOs, MCBs, surge protectors, neutral conductor ducts and, e.g., Arrow on D0-fuse-switches can be busbar-connected in phase together.

Busbar



ISS90916

Schrack-Info

- Universal busbar
- Push-on in the 9 mm module step
- Any required configuration of the connection flags without breaking off

Technical Data

Busbar cross section:	Cross section according current
Cross section:	10 mm ² , 16 mm ²
Max. current Is / Phase	63 A, 80 A
	125 A (Feeding in the middle)
Rated voltage Un:	400 V (415 V)
Impulse voltage strength Ui:	3000 V
Shit circuit strength:	25 kA at back up fuse 100 A gL in panels according EN 61439

ISS90916 Dimensional drawing

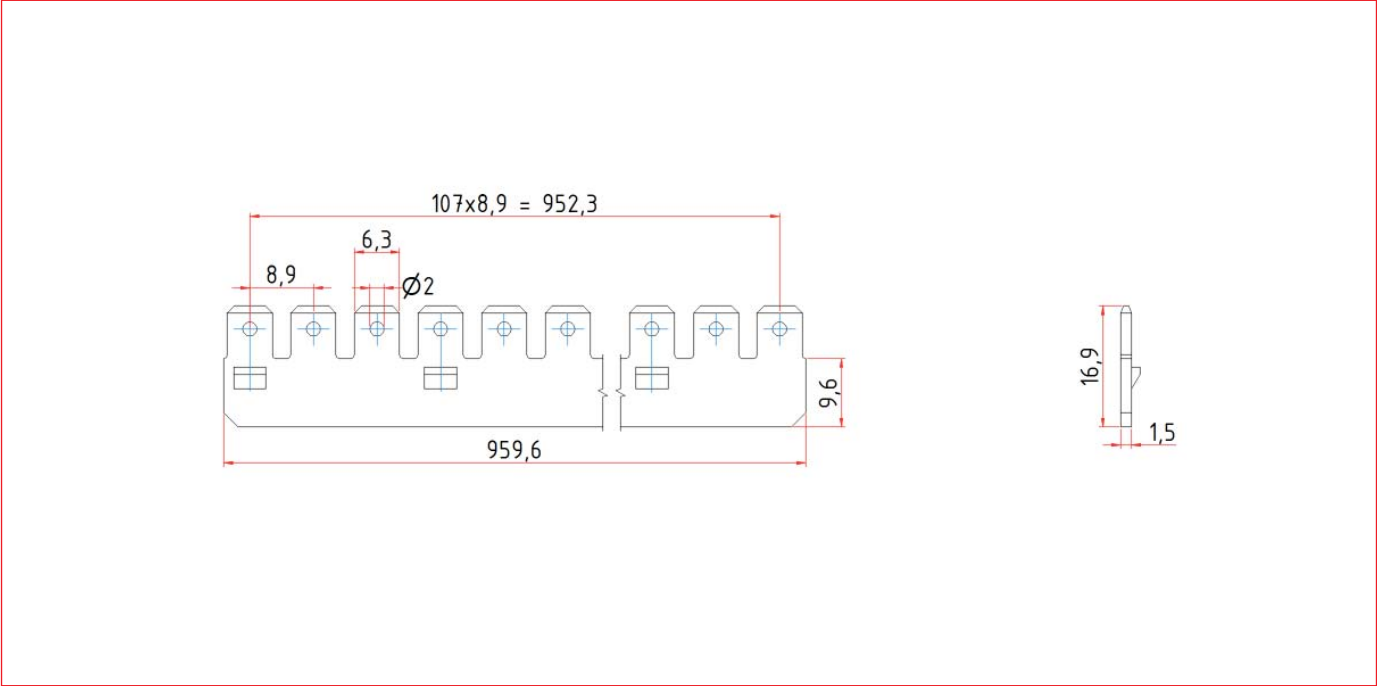

DESCRIPTION	AVAILABLE	ORDER NO.
Busbar, 80A, 1 pole, 16mm ² , MW=9mm		ISS90916

Insulation body



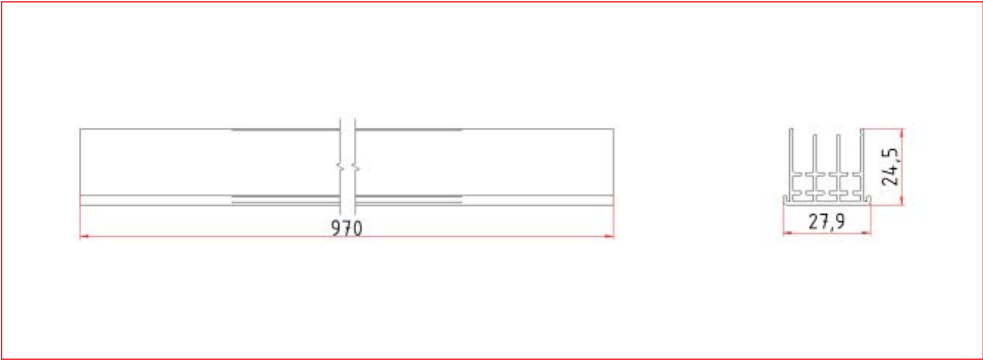

ISS90004

ISS90003 Dimensional drawing

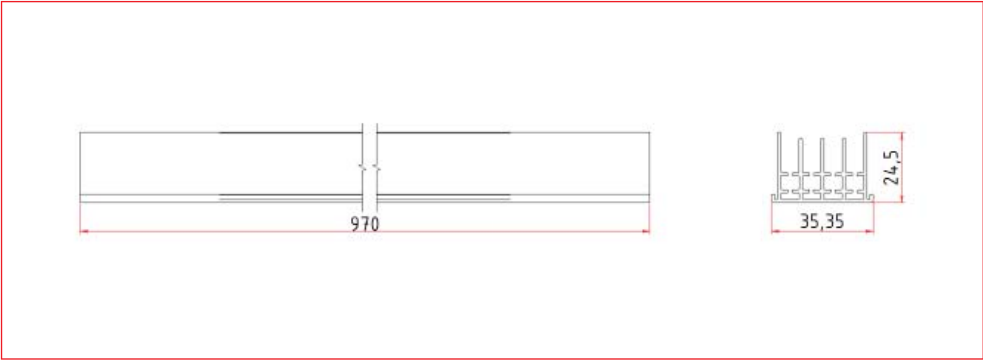

ISS90004 Dimensional drawing



DESCRIPTION	AVAILABLE	ORDER NO.
Insulation body, 3pole		ISS90003
Insulation body, 4pole		ISS90004



Connection flag



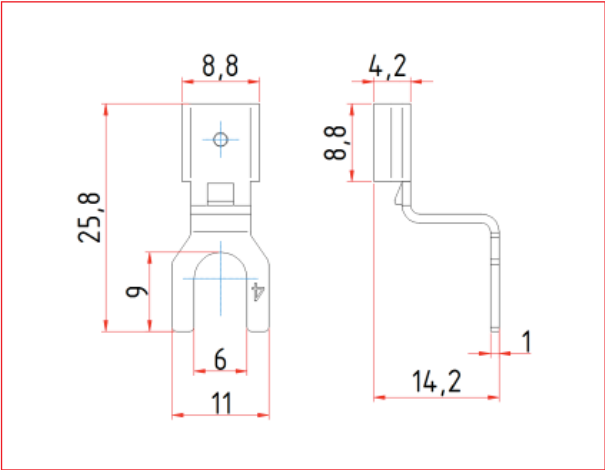

ISS909G1

ISS909G1 Dimensional drawing

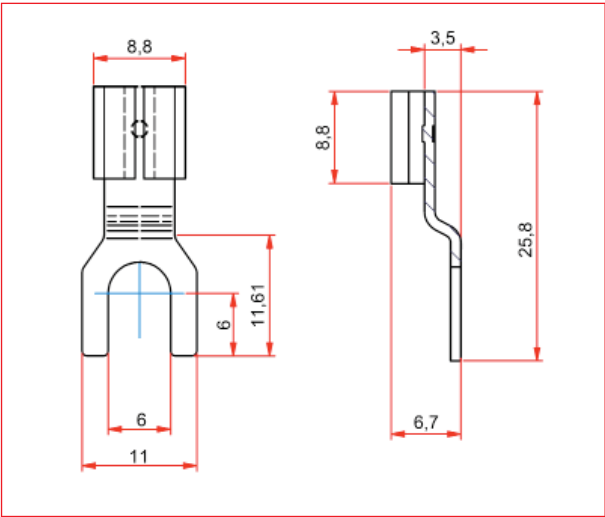

ISS909G2 Dimensioned drawing



DESCRIPTION	AVAILABLE	ORDER NO.
Connection flag, L1/N Pin		ISS909G1
Connection flag, L2/L3 Pin		ISS909G2



Accessories

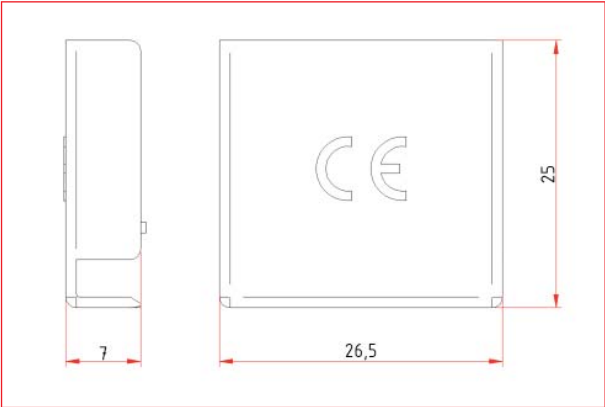

ISS900K4

ISS900K3 Dimensions



DESCRIPTION	AVAILABLE	ORDER NO.
End Cap for insulation body 3 pole		ISS900K3
End Cap for insulation body 4 pole		ISS900K4

