













Plug-in Relays

Power Relays Series RT

DESCRIPTION	AVAILABLE	ORDER NO.
Modules Matching Plug-in Socket for Power Relays RT		
LED module, red, 6-24V AC/DC, EM07		YMLRA024
LED module, red, 6-24V DC, A1+, EM18		YMLRD024-A
LED module, red, 6-24V DC, A1-, EM08		YMLRD024
LED module, red, 110-230V AC, EM06		YMLRW230
LED module, green, 6-24V AC/DC, EM11		YMLGA024
LED module, green 6-24V DC with protection diode, A1+, EM12		YMLGD024
LED module, green, 110-230V AC, EM10		YMLGW230
Protection diode module 6-230V DC, A1+, EM09		YMGD024
RC Network module 6-60V AC, EM02		YMRCW024
RC Network module 110-230V AC, EM03		YMRCW230
Varistor module, 24V-AC, EM04		YMWAW024
Varistor module 230V-AC, EM05		YMWAW230

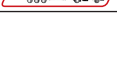
Pluggable Interface Relay XT



XT484LC4



RT7872P



YRT78624



YMLRA024

Schrack-Info

- 1 pole 16 A, 2 poles 8 A, 1 or 2 CO
- AC or DC coil, sensitive coil 400 mW
- Reinforced insulation, appliance class II (VDE 0700)
- Safe disconnection compliant with VDE0160 in combination with socket YRT78626
- 4 kV, 8 mm coil/contact
- Lockable manual testing system (see drawing “How To Use”)
- Optional model with mechanical and/or electrical indication
- Suitable for standard RT sockets
- Recyclable packaging
- Complies with the 2002/95/EC RoHS Directive
- For control panels, machine building

Dimensions (mm)

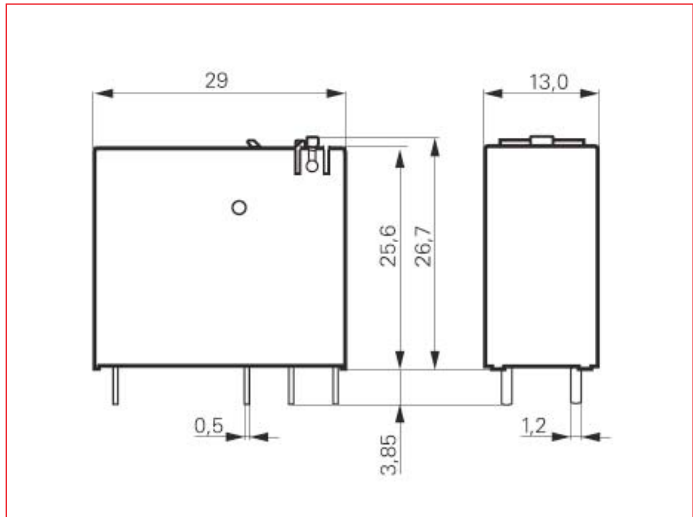

Pluggable Interface Relay XT

Circuit Diagrams

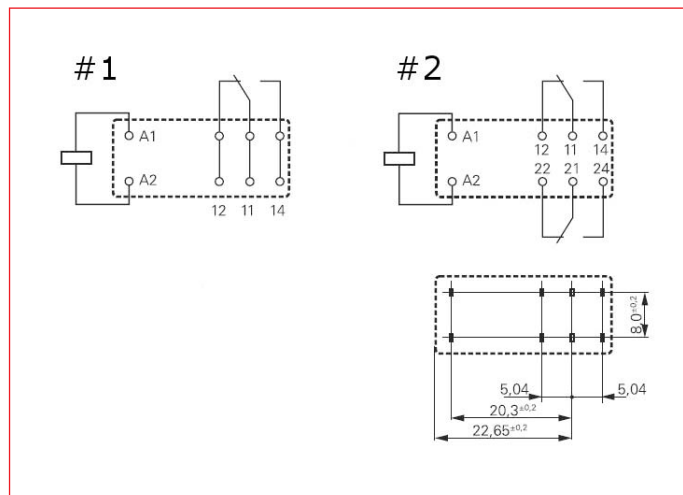

How To Use

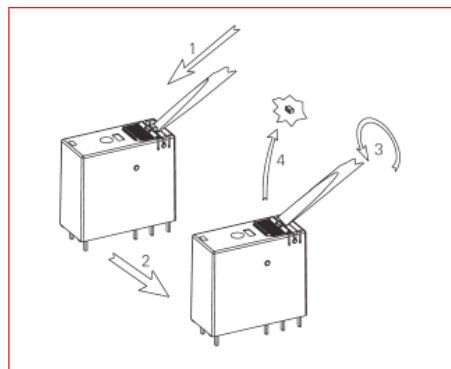

How To Use

Description of the locking function: If the test button is pulled out to forcibly, it may skip the test position and move directly to the locking position. To go to the locking position, please remove the plastic locking cam (see drawing).

Circuit Diagrams

#1	16 A, 1 CO
#2	8 A, 2 CO
General info	View of the terminals, dimensions in mm

Rated Breaking Capacity & Coil Operating Voltage Range

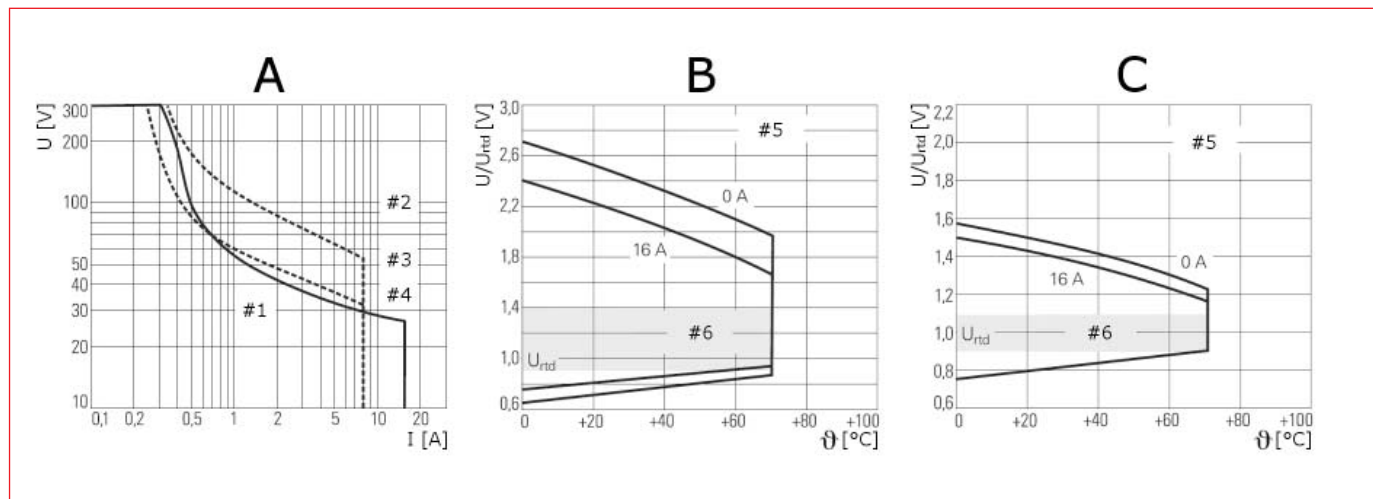

Rated Breaking Capacity & Coil Operating Voltage Range

A	Max. DC rated breaking capacity
B	Coil operating range DC
C	Coil operating range AC
U	DC voltage in [V]
U/U _{rtd}	Coil voltage in [V]
I	DC current in [A]
θ	Ambient temperature in [°C]

#1	1 pole 12 / 16 A resistive load
#2	2 pole 8 A resistive load
#3	2 contacts in series
#4	1 contact
#5	Versions without LED
#6	Recommended voltage range in [V]

Pluggable Interface Relay XT

Technical Data

CONTACT DATA		1-POLE	2-POLE
Number of contacts and type		1 CO	2 CO
Contact style		Single contact	
Rated current		16 A	8 A
Rated voltage/ max. switching voltage AC		240 / 400 V~	
Limiting short-time current, 30 ms		300 A	
Max. rated breaking capacity AC		4000 VA	2000 VA
Inrush current (max. 4 s at 10 % DF)		30 A	15 A
Contact material		AgNi 90/10	
Minimal contact load		12 V / 10 mA	
COIL DATA			
Rated voltage	DC coil	6...110 V	
	AC coil	24...230 V~	
Rated power	DC coil	typ. 400 mW	
	AC coil	typ. 0.75 VA	
Operative range, IEC 61810		2	
Coil insulation system according to UL1446		Class F	
Operation-/ release voltage/ coil resistance at ambient temperature 23 °C	24 V DC coil	16.8 V / 2.4 V / 1440 Ω ± 10 %	
	24 V AC coil	18 V / 3.6 V / 350 Ω ± 10 %	
	230 V AC coil	172.5 V / 34.5 V / 32500 Ω ± 10 %	

DESCRIPTION	AVAILABLE	ORDER NO.
Pluggable Interface Relay XT		
24V-DC, 1 CO, 16A, with LED and protection diode		XT374LC4
24V-DC, 2 CO, 8A, with LED and protection diode		XT484LC4
24V-AC, 2 CO, 8A, with LED		XT484R24
230V-AC, 2 CO, 8A, with LED		XT484T30
Spring Clamp Terminal Socket for Relays Series XT		
DIN rail mounted plug-in socket for RT2x, RT3x, RT4x, XT, RP4x relays, pinning 5mm, max. 16A, with spring clamp terminals		RT7872P
Retaining clip for RT relays with ejection function		RT17017
Retaining clip for XT and RP relays with ejection function		XT17017
Jumper link for connection of RT7872P		RT170P1
Plug-in Socket for Relays Series XT		
DIN rail mounted plug-in socket for RT1 x relays, pinning 3.5mm, max. 12A, I/O - logical arrangement, with screw terminals		YRT78624
DIN rail mounted plug-in socket for XT, RT2x, RT3x, RT4x relays, pinning 5mm, max. 12A, I/O - logical arrangement, with screw terminals		YRT78626
DIN rail mounted plug-in socket for RT2x, RT3x, RT4x relays, pinning 5mm, max. 16A, conventional arrangement, with screw terminals		RT78725
Retaining clip for RT relays with ejection function		RT17017
Retaining clip for XT and RP relays with ejection function		XT17017
Jumper bar for connection of up to 8 RT-sockets		RT170R8
Marking tag (for YRT sockets YRT78624 and YRT78626)		YRT16040
Accessories for Series XT Sockets		
LED module, red, 6-24V AC/DC, EM07		YMLRA024
LED module, red, 6-24V DC, A1+, EM18		YMLRD024-A
LED module, red, 6-24V DC, A1-, EM08		YMLRD024
LED module, red, 110-230V AC, EM06		YMLRW230
LED module, green, 6-24V AC/DC, EM11		YMLGA024
LED module, green 6-24V DC with protection diode, A1+, EM12		YMLGD024
LED module, green, 110-230V AC, EM10		YMLGW230
Protection diode module 6-230V DC, A1+, EM09		YMFDG230
RC Network module 6-60V AC, EM02		YMRCW024
RC Network module 110-230V AC, EM03		YMRCW230
Varistor module, 24V-AC, EM04		YMVAW024
Varistor module 230V-AC, EM05		YMVAW230